









LEGENDA

- vasca CLS a tenuta Imof 
- tubazioni scarico acque nere in PVC 
- pozzetto di ispezione con caditoia sez.int. 45x45 cm. 
- sifone tipo "Firenze" con ispezioni 
- pendenza tubazioni 
- dispositivo prelievo campioni 
- colonna di scarico acque meteoriche 
- collettore di scarico acque chiare 

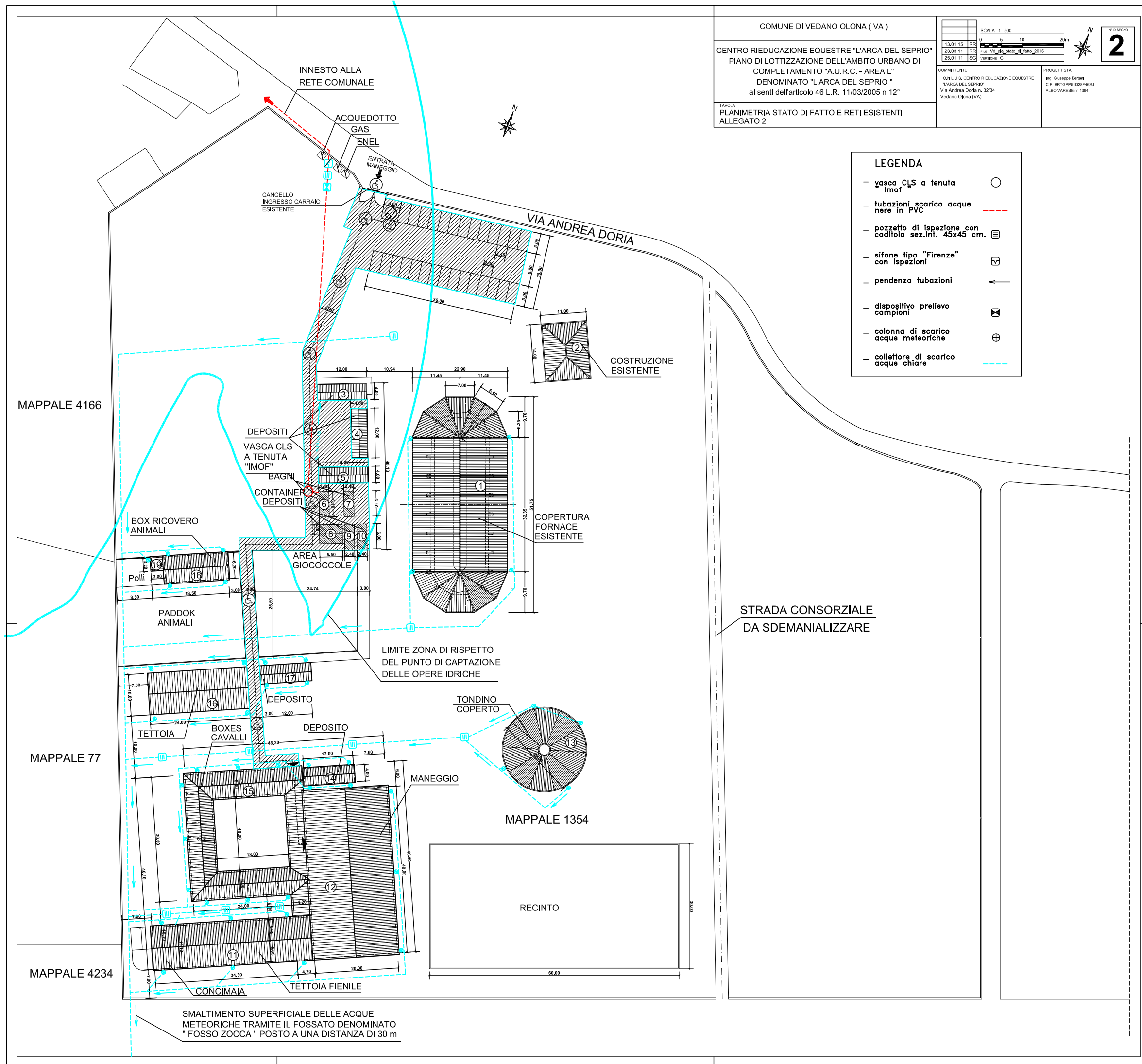

SMALTIMENTO SUPERFICIALE DELLE ACQUE METEORICHE TRAMITE IL FOSSATO DENOMINATO "FOSSO ZOCCA" POSTO A UNA DISTANZA DI 30 m